

**UNIVERSAL  
FLOOR INDUSTRY**



**UNIVERSAL  
FLOOR-INDUSTRY**



## Carpenter Decoration Tools

Innovating tools for the set up  
of laminate flooring and vinyl,  
plus a range  
of flooring tools.



**UNIVERSAL  
FLOOR INDUSTRY**

Laminate / MDF flooring / vinyl cutting solutions

### 089755 LAMINOCUT 2

⚖ : 3460 g Bar code : 3476060008978

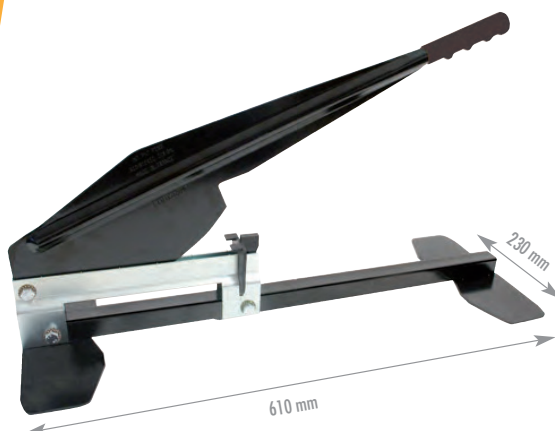

#### Laminate/MDF flooring/Vinyl cutting guillotine

- Neat cut without damaging the melamine surface.
- No breathable dust.
- No noise.
- No sharpening required ever on blade.



#### 3 possible cutting widths :

- Straight cut.
- Angle cut from 0° to 90°.
- Cuts in length.
- Cuts up to 11 mm (0.393") thickness.
- Protective felt pads.

### 089055 STRATICUT®

### SUPERPROSERIE®

⚖ : 8030 g Bar code : 3476060008909



#### Laminate/MDF flooring/Vinyl cutting guillotine

- Neat cut without damaging the melamine surface.
- No breathable dust.
- No noise.
- No sharpening required ever on blade.



- Protective felt pads.
- Max. cutting width : 210 mm.
- Cuts up to 11 mm (0.393") thickness.
- Also includes :
  - 1 mini tresle for long boards.
  - 1 waste collector.



**089955 VARIOCUT**
**SUPERPROSERIE®**

n° : 12450 g Bar code : 3476060008992

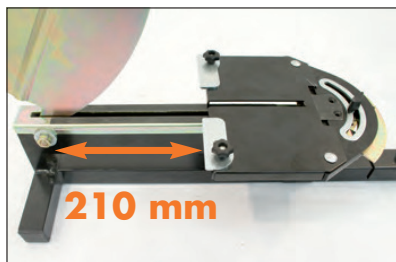
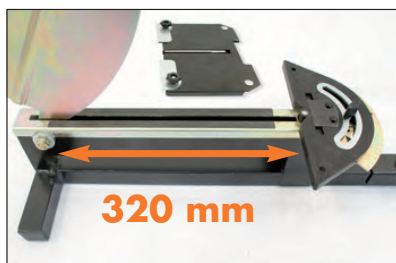
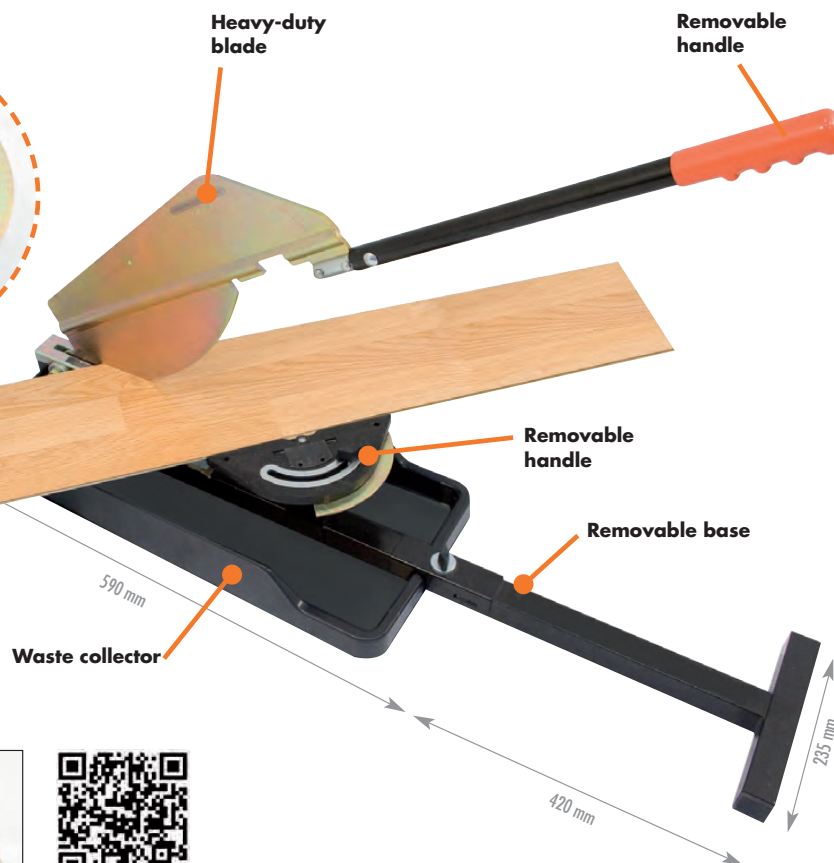
**Laminate/MDF flooring/Vinyl cutting guillotine for straight and up to 90° angle cuts**

- Neat cut without tearing of laminate layer.
- No breathable dust.
- No noise.
- No sharpening required-EVER.

- Up to 320 mm straight cutting and up to 210 mm for angle cutting.
- Cuts up to 15 mm (0.590") thickness.
- Up to straight cuts and up to 0-90° angle cuts are possible.
- Protective felt pads.
- Also includes :
  - 1 mini trestle for long boards.
  - 1 waste collector.
  - Removable board stopper for 210 mm cut.

**UNIVERSAL  
FLOOR-INDUSTRY**

Solid &amp; laminate parquet floor installation solutions

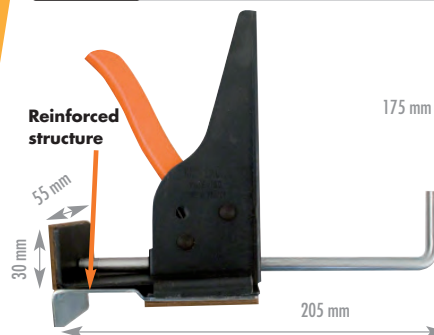

**088055 KIK-BACK**

Poids : 1240 g both Bar code : 3476060008800

**Set of 2 floor panelling power presses**

■ Regular pressure : 250 kg.

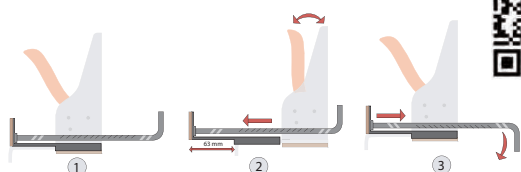
- Ensures optimal alignment and installation of wooden flooring.
- Holds the planks tightly together while the glue dries.



- Also allows the laying of last board.
- Ratchet : 54 steps of 1.5 mm.
- Max. opening : 67 mm, protective pads included.

**087055 SET TAK-TIK**

Poids : 435 g Bar code : 3476060008701

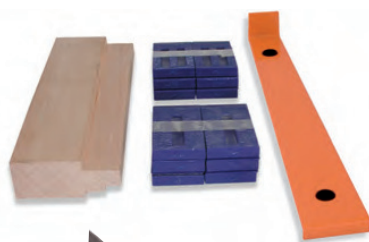
**A complete set for installing laminate flooring (click-together design)**

■ A must for laying laminate and MDF floorings.

■ The set includes :

- 1 pulling bar (metal frame) : used to move the boards lengthwise to remove gaps when adjusting flooring boards.
- 1 wood knocking block (wooden frame) : a protection block when fitting and

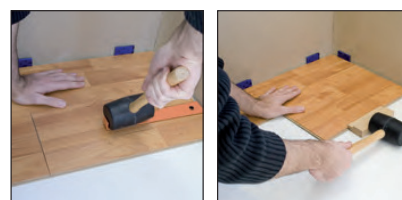

adjusting tongue-and-groove wood flooring boards.

- 20 spacer blocks : they keep the flooring square with the wall to allow the parquet flooring to have a good position.

**087355**

Bar code : 3476060008732



- 40 spacer blocks set

**087155 MINI TAK-TIK**

Poids : 550 g Bar code : 3476060008718

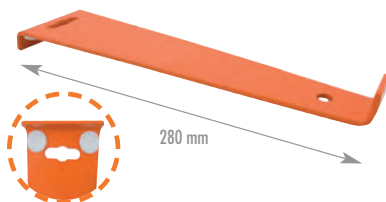
**Basic pulling bar for laminate flooring installation (click-together design)**

■ Used to move the boards lengthwise to remove gaps when adjusting flooring boards.

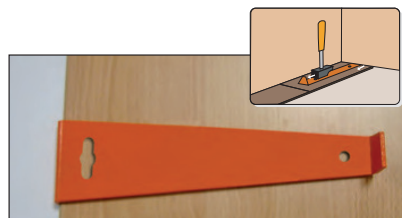
**087255 SUPER TAK-TIK**

Poids : 2027 g Bar code : 3476060008725

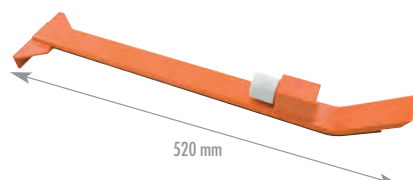
**Professional pulling bar for laminate flooring installation (click-together design)**

■ Heavy-duty.

■ Nylon hammer block for all metal hammers or mallets.

■ With crowbar system.

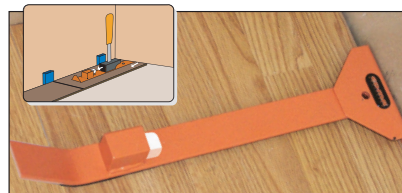

- Wide head for greater pulling surface.
- Soft-touch material covers the base of the pulling bar to protect the laminate flooring.
- Replaceable nylon block.

**262855**

Poids : 16 g Bar code : 3476060026286

**Nylon tip**

**085055 CAMELEON 130**

⚖ : 2938 g Bar code : 3476060008503

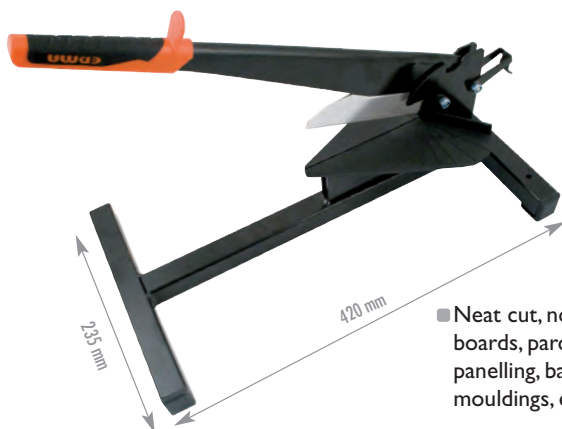

45° to 90° cut

**Mitre guillotine with an interchangeable 130 mm stainless steel blade**

- Neat cut, no dust : wooden skirting boards, parquet flooring boards, panelling, battens, door frame mouldings, etc...

- Excellent cutting quality up to 28 mm (height) and 130 mm (length) with a range of angles from 45 to 90°.

- Long handle for a fast and easy cut.
- Ideal for cutting European woods (oak, beech...), american woods (cherry, southern yellow pine...), northern pine, PVC panelling, MDF panelling...

**071055 MULTI-COUP'® EXTRA**

⚖ : 384 g Bar code : 3476060007100

**Mitre shears with variable angle cuts**

- Neat and effortless cut !

- Opening allows easy cutting of : decorative moulding, wood skirting boards, rubber seals, PVC sections.

**071155** ⚖ : 36 g Bar code : 3476060007117

**65 mm blade**  
for Multi-coup'® Extra

- Can be re-sharpened.

**TECHNOCLEAN**
**097055** ⚖ : 136 g Bar code : 3476060009708

**TECHNOCLEAN 40**  
215 mm 40 mm

**097155** ⚖ : 170 g Bar code : 3476060009715

**TECHNOCLEAN 60**  
60 mm

**097255** ⚖ : 206 g Bar code : 3476060009722

**TECHNOCLEAN 80**  
80 mm

**Hand scraper**

- 2 replaceable hardened double steel blades, that can be turned around ; up to 4 times more scraping capacity with only one set of blades.

- Handle with ergonomic and non-slip design.

- Ideal for the removal of glue down carpet/linoleum, wallpaper; adhesive remnants, swaging of tubes made from different materials.

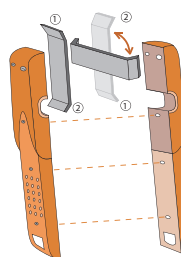
**086655 RENOV'JOINT**

⚖ : 78 g Bar code : 3476060008664

**Wood strip flooring joint claw**

- Cleans wood strip joints before varnishing.
- With opener.

**Integrated bottle-opener.**

**EDMA®**



**UNIVERSAL  
FLOOR-INDUSTRY**

Decoration tools solutions



**086455 REVOCUT**

± : 3630 g Bar code : 3476060008640



**Max. width 50 mm**



#### Threshold strip guillotine

- Neat cut without any effort !
- Specially ½ curved.
- Stainless steel : 50 mm x 1 mm.
- Brass : 50 mm x 1.2 mm.
- Aluminium : 50 mm x 1.7 mm.

**160855 UTILITY KNIFE**

**SUPERPROSERIE®**

± : 293 g Bar code : 3476060016089



#### For utility or hook blades

- Retractable blade with locking action.
- Blade storage with 3 spare blades.
- String cutter.

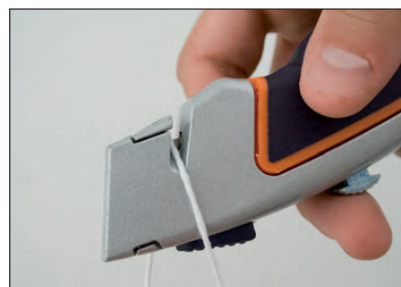

**199255**

± : 51 g - 3476060019929



Utility knife  
blade.

• x 10 pces.

**199655**

± : 50 g - 3476060019967



Hook knife  
blade.

• x 10 pces.

**079055 JUMBO CUT**

P : 3380 g Bar code : 347606007902

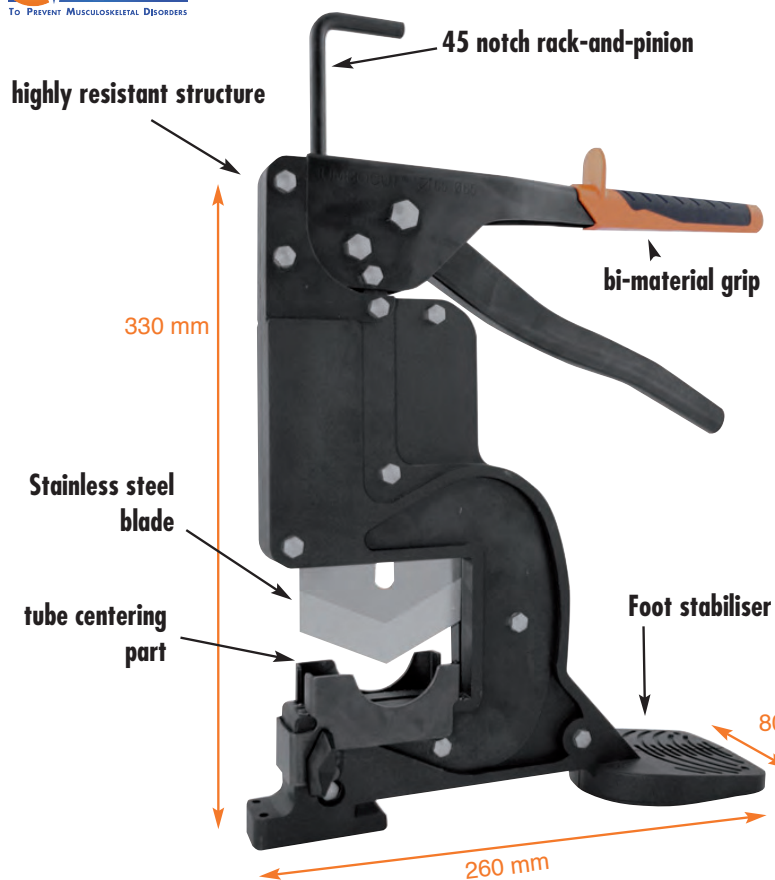

**Guillotine for cutting PVC gutters max.  
65x65mm**

- Neat cut without risk of break nor explosion of the material.
- Effortless cut thanks to its ratchet system.
- No noise, no dust.
- Replaceable blade.
- Plastic box included.

**also for PVC, PP, PEHD, PE, PER,  
ABS and multilayer tubes Ø 63mm.**

**079155**

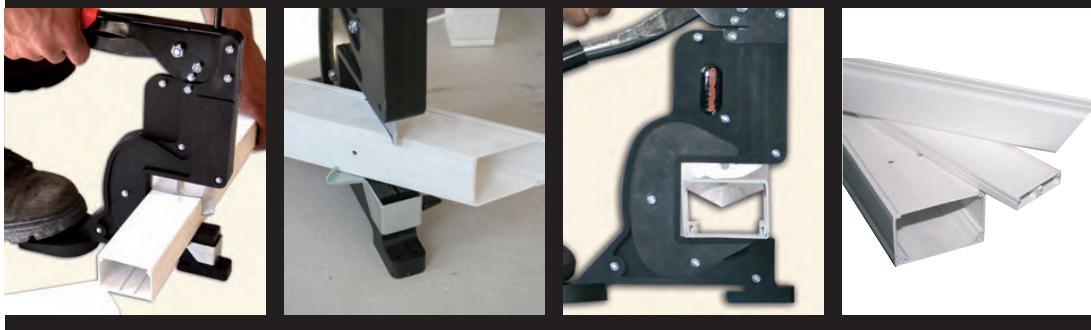
P : 160 g - 3476060007919

**Stainless steel blade  
for Jumbocut (079055).**
**FOCUS ON**



**UNIVERSAL  
FLOOR INDUSTRY**

Decoration tools solutions



### 161055 **PRESS PLAC PRO**

⚖ : 8600 g Bar code : 3476060016102



#### Vertical support for wood panels

- Holding height : 320 mm and Max. width : 58 mm.
- Lock screw for perfect holding.
- With carriage handle.
- Minimum working required space. for cutting, drilling or planing.

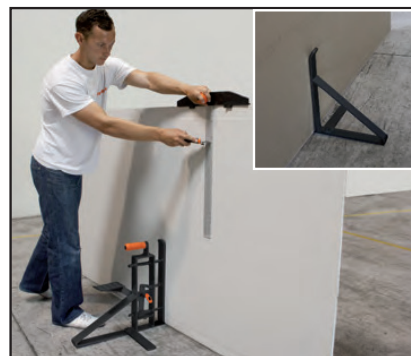

### 064555 **TRANSPLAC**

⚖ : 1154 g Bar code : 3476060006455



#### Board lifter (steel)

- New wide base for better panel seating.
- Allows boards and sheets to be carried by just one person.



### 064055 **DUOPLAC**

⚖ : 1237 g le jeu Bar code : 3476060006400



#### 2 board carrier handles

- Soft rubber grips - non-slip design.
- Carriers boards up to 50 mm thickness.
- 15 mm steel handles for board transport by 2 persons.
- Innovative, rugged design.
- Can be attached on a belt.



### 066055 **FOOTPLAC**

⚖ : 997 g Bar code : 3476060006608



#### Board lever with stirrup (steel)

- Wide base prevents board damage while improving panel seating.
- Also ideal for unhinging doors.
- New extra wide loop suitable for all safety footwear.



086555

**PRESS DECK**

: 2269 g Bar code : 3476060008657

**Wood or composite decking lath straightener**

- For all type of wood even IPE (amongst the most dense wood in the world).
- Wood use possible.
- over 200 kg strength.
- Hanging up of planks between 90 and 180 mm: against a wall.
- 1 fixed plank +  
3 planks of 90 mm  
2 planks from 90 up to 125 mm  
1 plank from 125 up to 180 mm



Ideal for vertical use

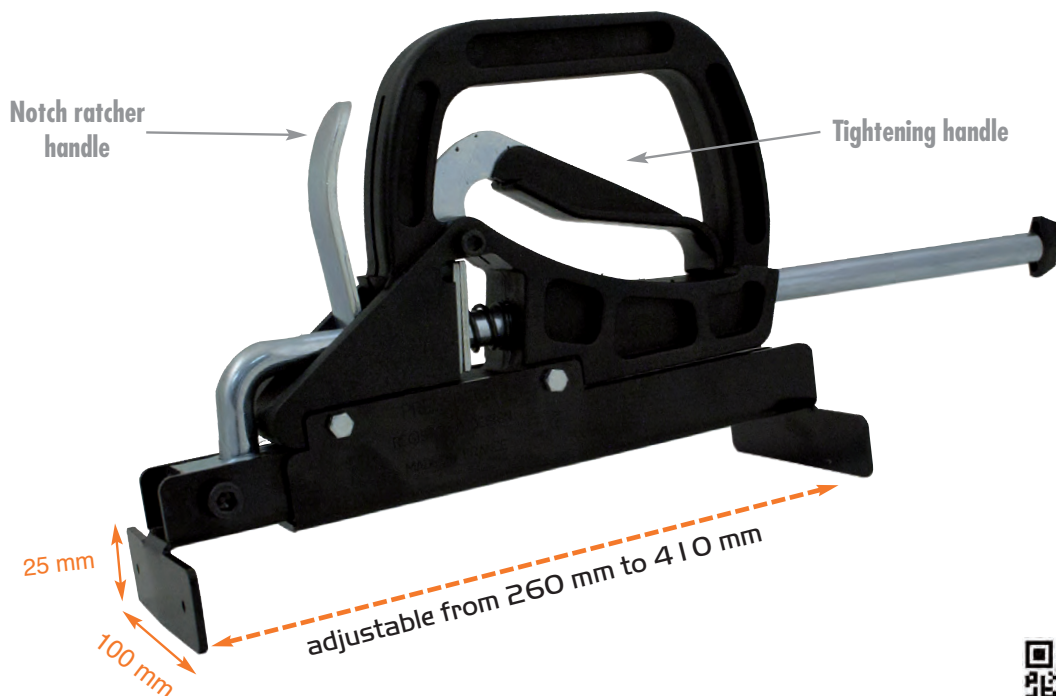

**Allows straightening up to the last lath even in thrust bearing**

