

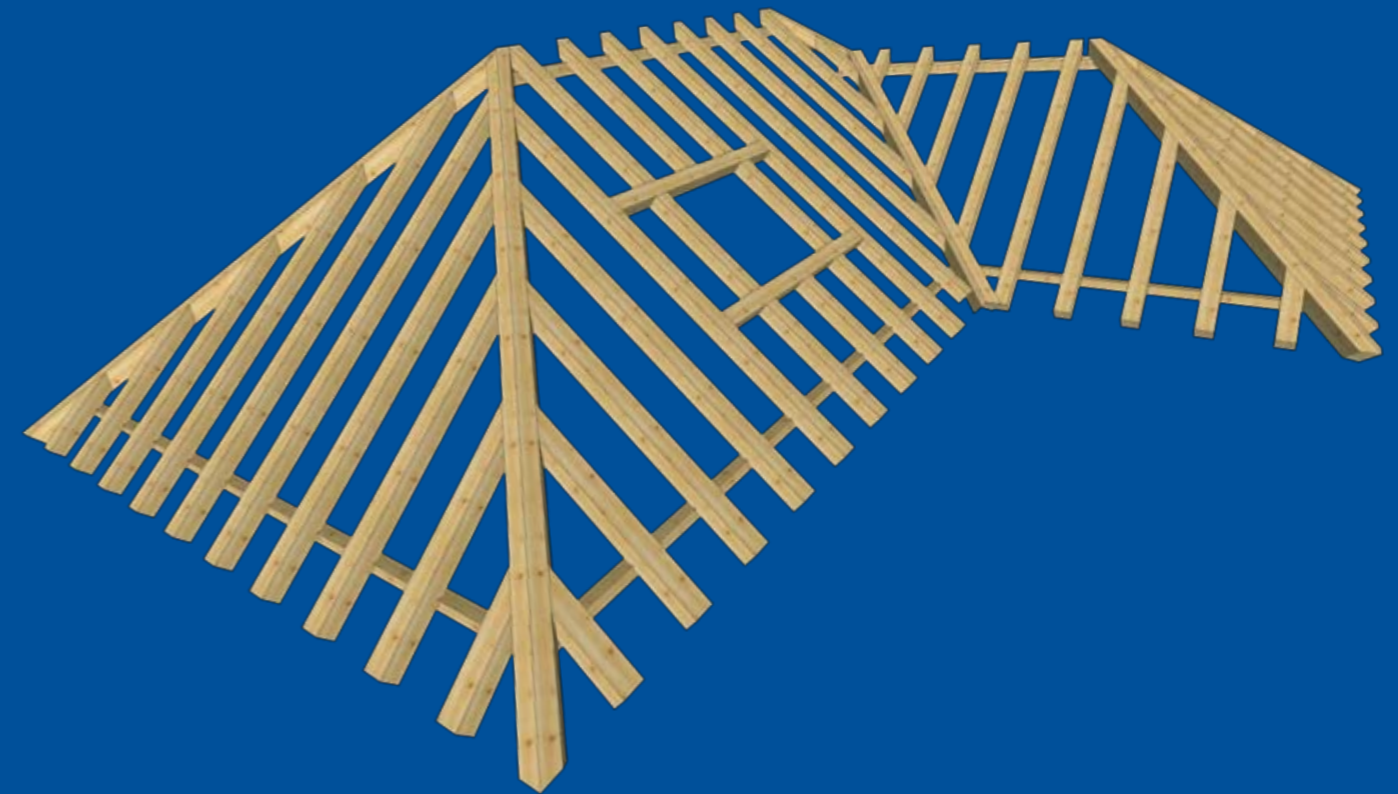

MAFELL AG

Postfach 1180
D-78720 Oberndorf a. N.
Germany
Phone + 49 74 23 / 812-0
Fax + 49 74 23 / 812-218
E-Mail mafell@mafell.de

www.mafell.com



Errors and omissions excepted - Printed in Germany - Order No. 902587 - 08/10

**Product Training
Carpentry Machines**

Product training courses:
The MAFELL training center.



The MAFELL training center was planned and designed by:
Pro Architektur - Gerhild Hamberger

MAFELL training courses

With a view to providing customers with more than simple technical assistance, MAFELL offers its employees effective training courses in modern foreign languages, telephone management and customer relationship management, among many other subjects. Further training is essential if we are to remain our customers' partner of choice on the issues that extend beyond engineering and technology.

MAFELL translates theory into practice.

In our newly furnished training center, we provide application and technical training courses for the MAFELL specialty dealers. All the MAFELL machines, in every product group, are examined and explained in active sessions.

MAFELL product training

Our technical seminars convey well-founded, expert knowledge to all the participants. Our skilled instructors impart both valuable facts and practical hints. Further information on our product training courses is available by phone on +49 74 23 / 81 22 78.

Contents

In the beginning there was wood	4 - 5
Roof shapes	6 - 7
Terminology	8 - 9
Classic styles: cross-hipped roof - Classic wood joints: machining detail	10 - 13
Modern solutions: timber engineering - Modern metal/wood joints: machining detail	14 - 17
Machining examples: Tenoner ZAF 200	18
Rafters/series production	19
Cutting depth chart	20
Cutting depth table	21
Contact	21
Notes	22 - 23

Introduction:

In the beginning there was wood

Adesirable material since time immemorial

We are more familiar with wood than with any other material. None of the trades that have emerged in recent millennia could have flourished without wood. It is used for tools and workbenches, in carpentry and cabinet making, and as a fuel and raw material.

Solid, split, machined, crushed, dissolved and burnt – wood remains an essential material.

It keeps us warm and clads our buildings, affording protection against cold and heat. The crib and stable in Bethlehem were made of wood. As paper, it carries and stores information. We eat and drink at wooden tables, sit on wooden chairs and sleep in wooden beds. We play with wood and make music with it. Smooth wood is warm and pleasant to the touch.

Constituents of wood

Wood consists of millions of cells, separated by insulating voids, with walls that absorb and expel moisture. Flooring, walls and furniture made of wood have identical properties and create a healthy climate in our living spaces. They can also be repaired.

Wood is infinitely renewable, so that we are able to use it in a sustainable way. Forests produce both wood and oxygen, protect the soil, safeguard clean water, offer a habitat for animals and other plants, and provide humans with a recreational environment.

Applications and processing

„Used“ wooden products are not past their useful life because they can still be exploited to recover energy. In many cases, they still harbor more (solar) energy than the amount consumed throughout their life cycle during production and disposal.

Products made of wood are beautiful and diverse. More than 25 indigenous species are used in Europe according to sustainable principles, and each one has special properties.

No two pieces of wood are identical. Each piece differs by location or the age of the tree and depending on whether harvested as heartwood, sapwood, roundwood or limbwood – there is a suitable wood for every purpose. It is durable, adaptable, attractive and practical. It is easy to work, frugal with energy and highly conducive to repair.

Wooden products are sustainable and for the future, and they represent value for money. A cross-section of a tree reveals its age, the plentiful and the meager years, and the changing pattern of overshadowing during its lifetime.

(Source: <http://www.forst-hamburg.de/holz.htm>)

The history of carpentry extends as far back as primeval times.

Weather conditions and the need for protection against wild animals compelled people to build shelters even in the very early days. It has been found that prehistoric man first used the tree as a dwelling because it naturally afforded the best and most reliable protection.

Subsequently, underground and rock caves became the first dwellings to accommodate humans for thousands of years.

Not until much later did nomadic tribes live in portable tents made of poles and animal skins. The tent shape gave rise to a form of gabled roof with a ridge purlin or beam supported by two trunks with forked branches. The rafters rested on wooden sleepers on the ground.

These simple structures were followed by huts, which initially consisted of roundwood, rammed into the soil, carrying closely spaced roof timbers in a triangular formation, tied with bast rope. The framework was covered with reeds, grass and soil. The more substantial log cabin appeared around 4000 BC. In the earliest examples, the walls and roof were constructed from rough tree trunks.

It was the invention of tools, such as the axe, hammer and saw, that paved the way for the more sophisticated shaping of wood. The first wheel was made by slicing a horizontal section from a tree trunk, beams and planks were formed by slitting a trunk lengthwise, and the first joints – scarf and tenon joints – were produced by sawing.

The pile buildings in the Federsee bog in Württemberg and some lakes in Switzerland, especially on Lake Constance, bear testimony to timber construction in primeval times. The piles discovered there are still standing and estimated to be 5,000 years old. It is assumed that experts emerged and placed their house building skills at the disposal of their neighbors as civilization and human settlements developed. The craft of wood construction continued to be refined thereafter for many centuries.



Two traditional half-timbered gables provide a fine example of the art of building.

Buildings of the 16th and 17th centuries

During this period, timber structures were consistently very solid and in most cases built far too strong for their purpose, which gave rise to the pointless over-felling of the precious natural raw material.

Although we still delight in the attractive half-timbered buildings from this era, many are marred by major design defects or are simply not fit for purpose.

This fact is attributable to the builders' lack of a theoretical understanding of statics and strength of materials. With the requisite knowledge now at our disposal, we are able to use wood in an entirely different, more purposeful and therefore economical way.

Timber frame construction will retain its appeal in some regions, even in the future, but stone and brick have gradually become the materials of choice in most cases.

The carpentry trade has kept pace with change, however, and abandoned its more or less obsolete skills in favor of new fields of activity, including modern, well-conceived building methods with half roof trusses, frame or stud wall construction, and timber-saving laminated beams and rafters.

Pile dwelling settlement near Unteruhldingen on Lake Constance



Roof shapes

Gabled: Two sloping roof faces, creating a peak at the ridge.



Hipped: Four sloping roof faces each with two hips rising to a ridge across the top. Hipped houses have a horizontal roof-to-wall junction.

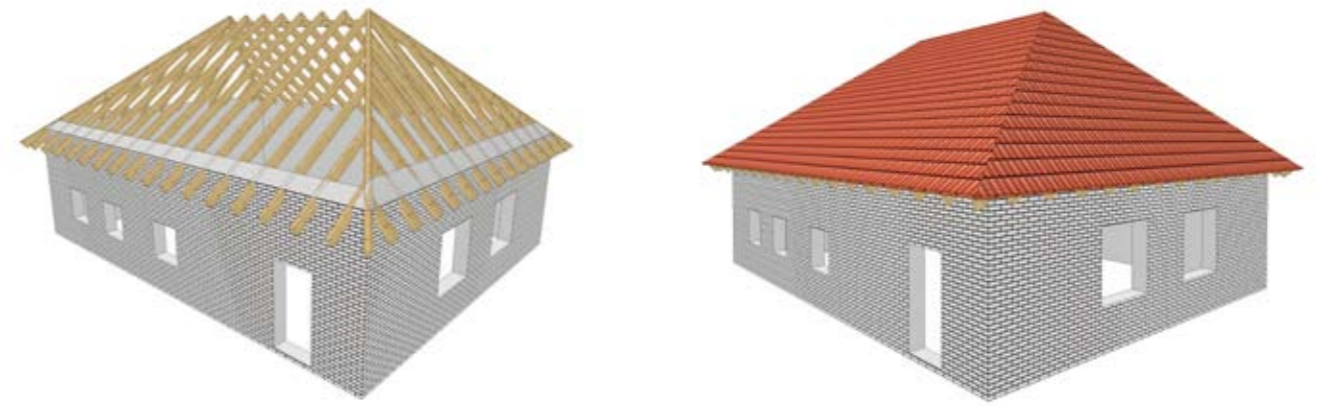

Pent or lean-to: Single sloping roof face.

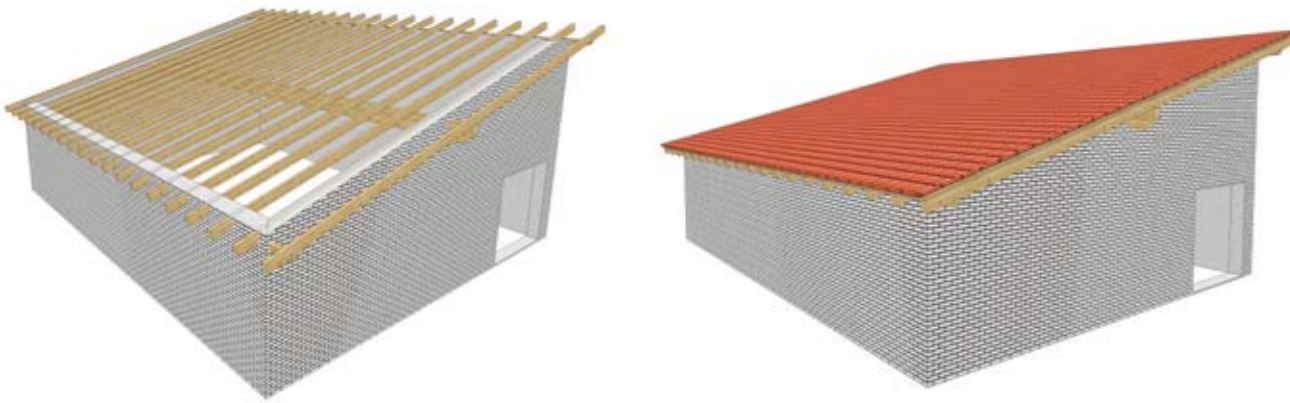

Half-hipped: Four sloping roof faces each with two hips rising to a ridge across the top. Half-hipped houses have a horizontal roof-to-wall junction on two sides and truncated gables on the other two sides.



Flat: A single horizontal roof face.

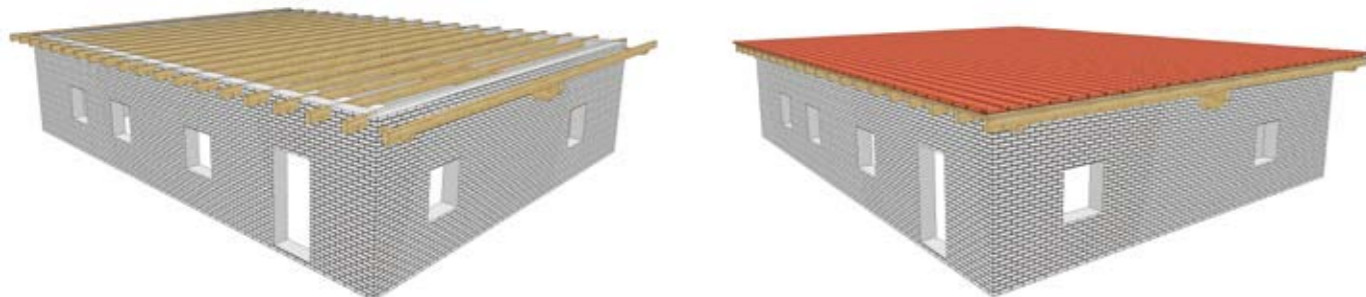

Turret: Several steep sloping roof faces each with two hips rising to a peak at the top.

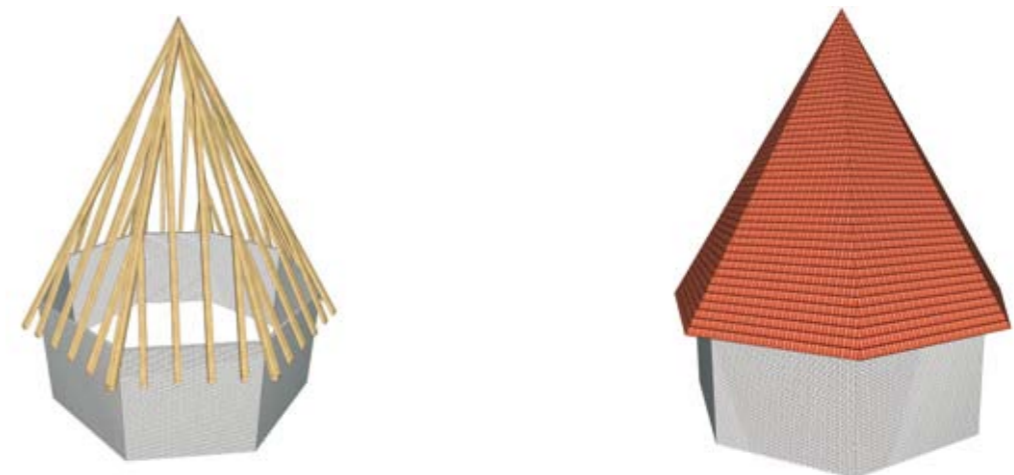

Terminology

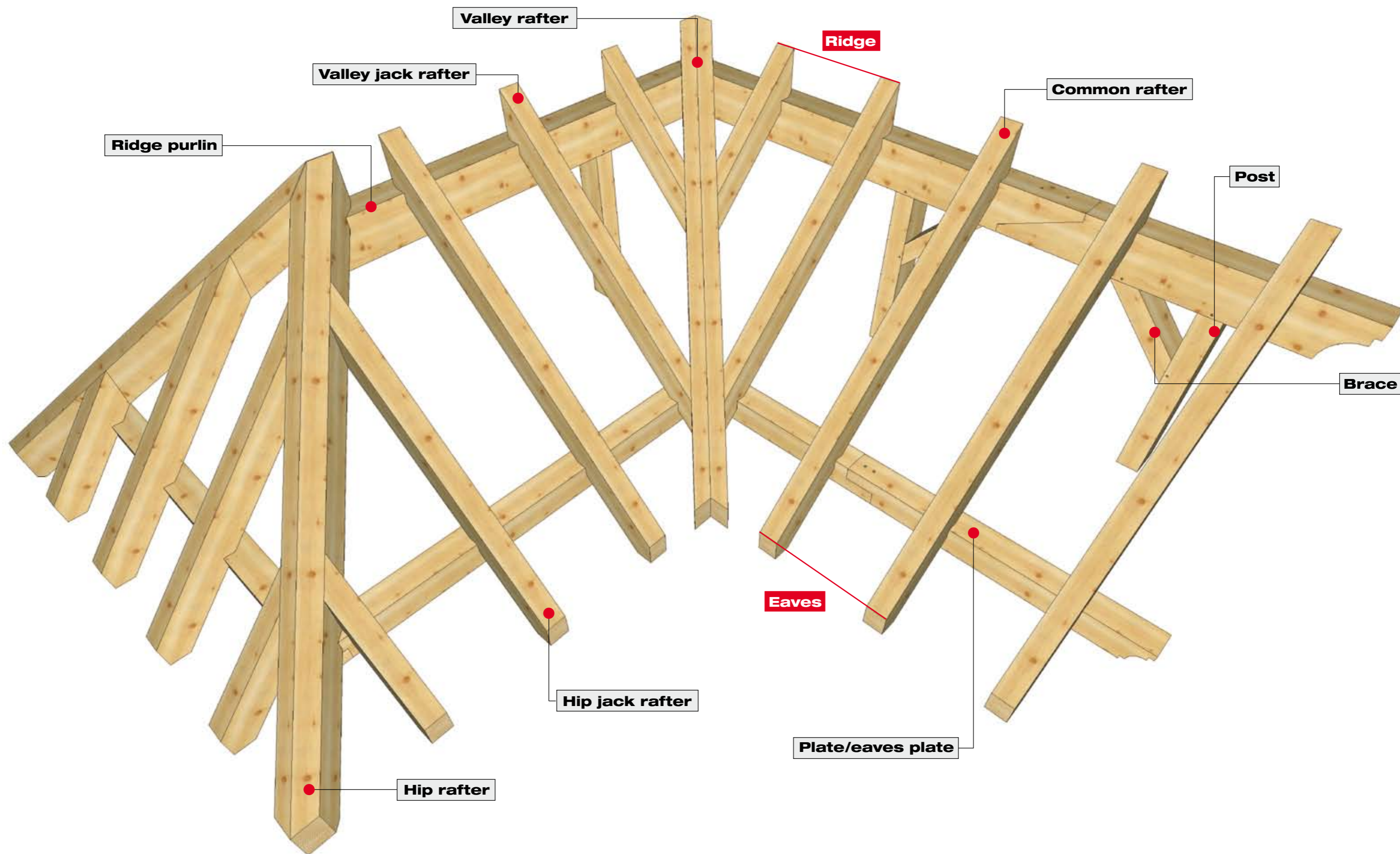

Classic
Cross-hipped roof.

All machining detail on page 12-13.

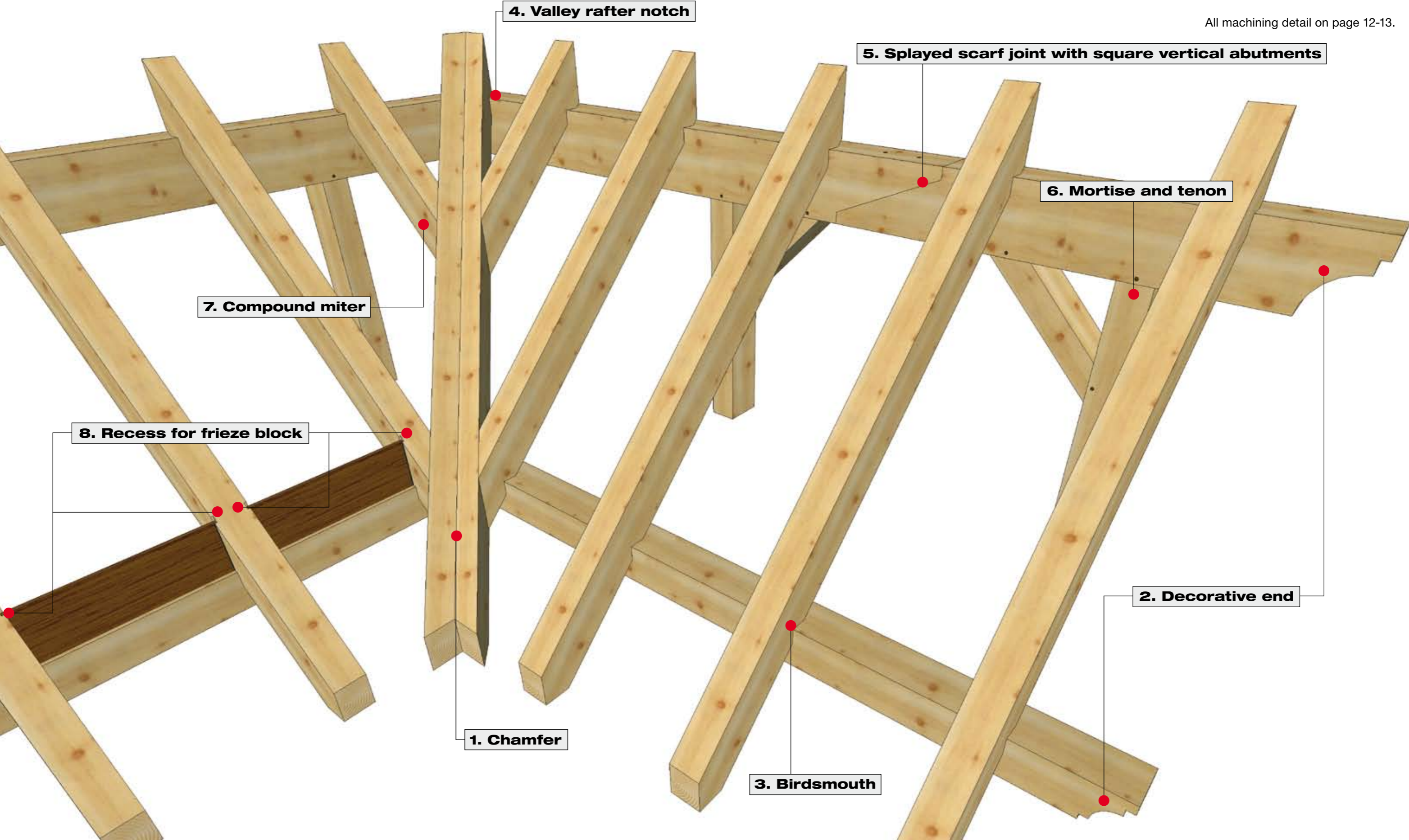

Classic wood joints:
Machining detail.

1. Chamfer

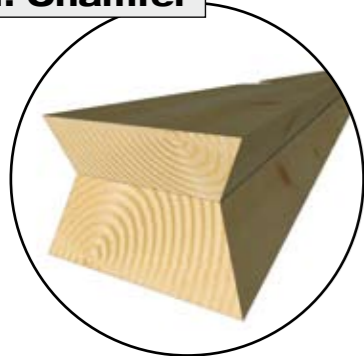

Portable Circular Carpentry Saw
MKS 130 Ec / MKS 185 Ec



Portable Circular Saw
KSP 85 Fc

For ripping, use sawblades with few teeth.

2. Decorative end

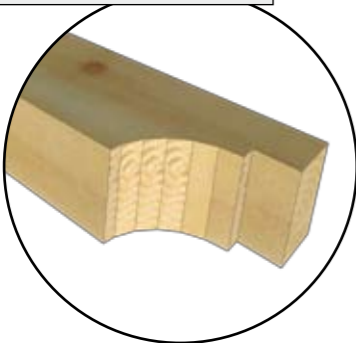

Portable Band Saws
Z 4 Ec / Z 5 Ec



Carpenter's Beam Planer
ZH 320 Ec
(for visible profile)

5. Splayed scarf joint with square vertical abutments

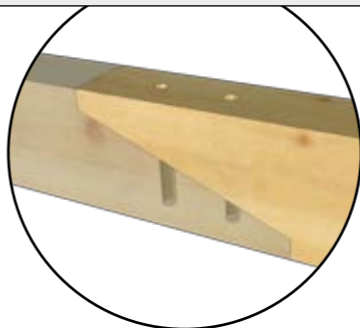

Drilling Station
BST 460 S

Drilling Machine
HB 2 E

or



Carpenter's Saw
ZSX Ec / 400 HM



Portable Band Saws
Z 4 Ec / Z 5 Ec

6. Mortise and tenon

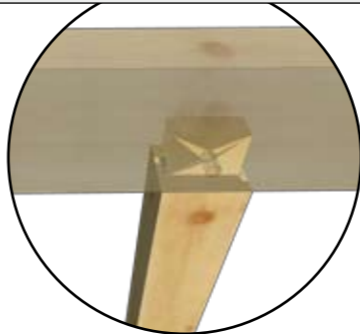

Tenoner
ZAF 200

or



Portable Circular Saw
KSP 85 Fc



Chain Mortiser
LS 103 Ec

Portable Band Saws
Z 4 Ec / Z 5 Ec

3. Birdsmouth

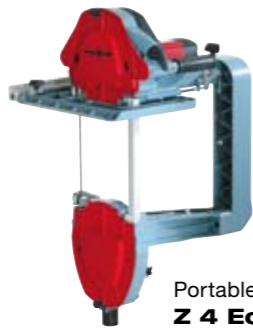
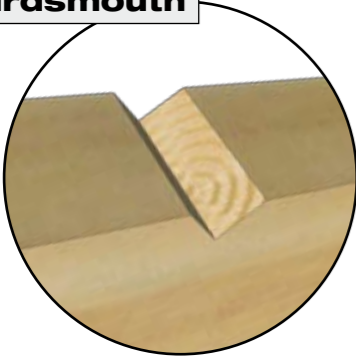

Portable Band Saws
Z 4 Ec / Z 5 Ec

or



Skew Notch,
Lap-Joint &
Tenon Cutter
ZK 115 Ec

7. Compound miter



Portable Circular Saw
MKS 165 Ec



Carpenter's Saw
ZSX Ec / 400 HM

4. Valley rafter notch

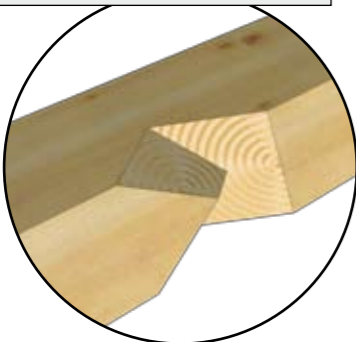

Carpenter's Saw
ZSX Ec / 400 HM

or



Portable Band Saws
Z 4 Ec / Z 5 Ec
(two-man)

8. Recess for frieze block

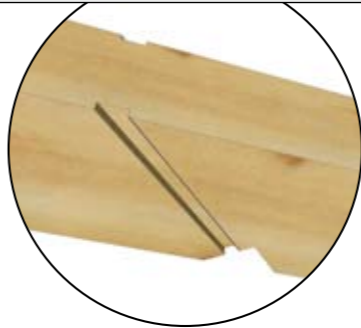

Groove-Cutting Machine
NFU 32
(recess for frieze block)

Cross-Cutting System
KSS 400
(cutting frieze block)

or

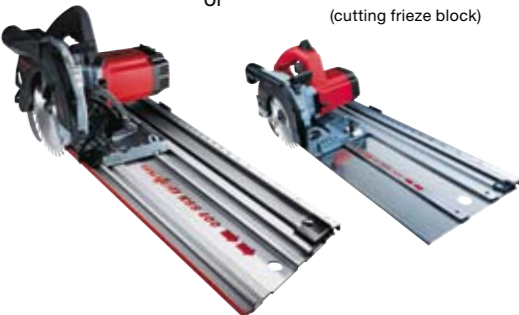

Cross-Cutting System
KSS 300
(cutting frieze block)

Modern:
Timber engineering

All machining detail on page 16-17.

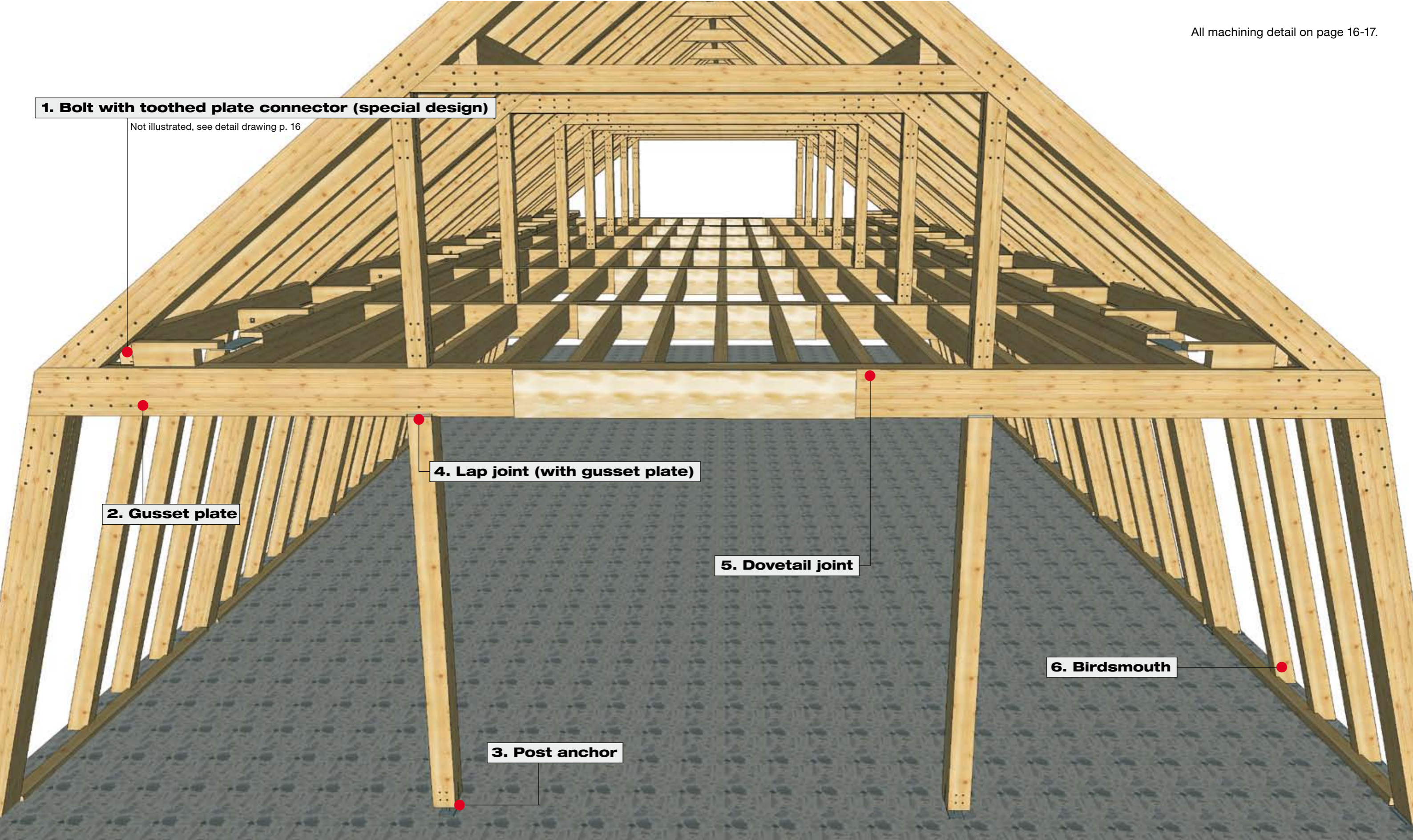

Modern metal/wood joints:
Machining detail.

1. Bolt with toothed plate connector (special design)

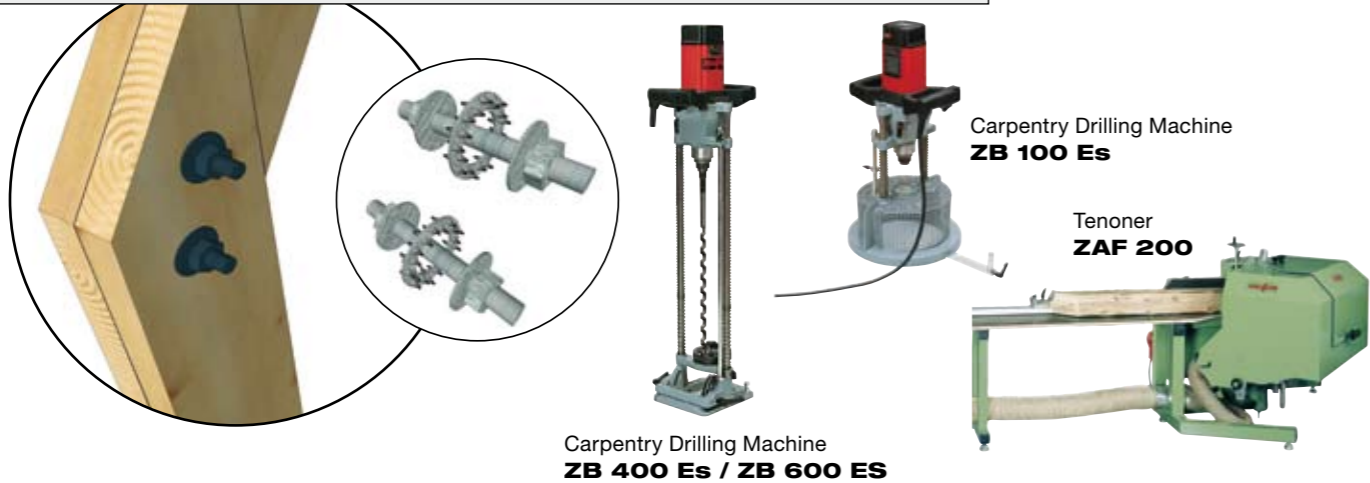

4. Lap joint (with gusset plate)

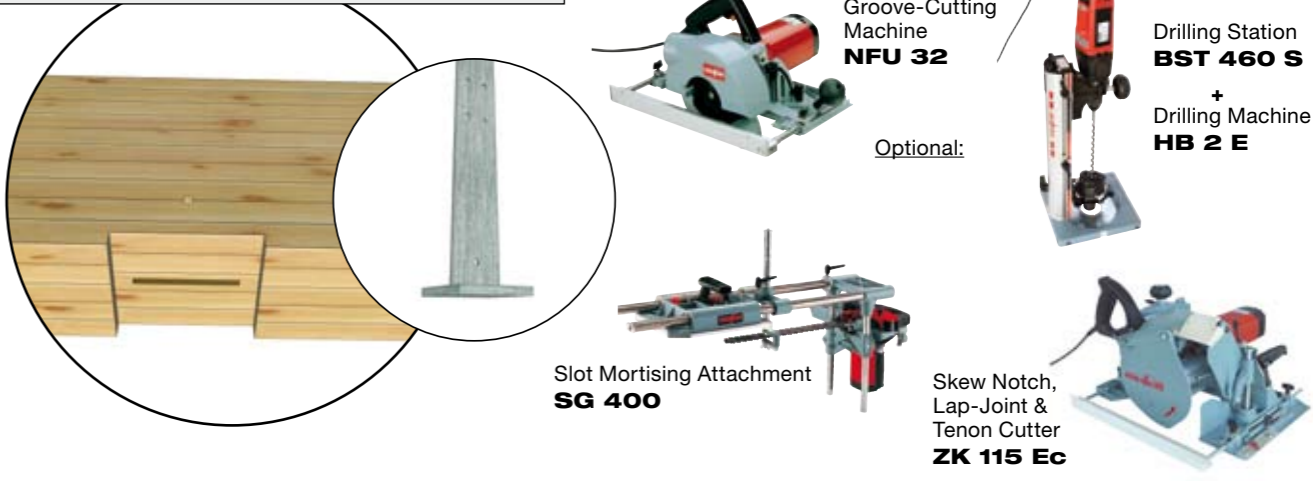

2. Gusset plate

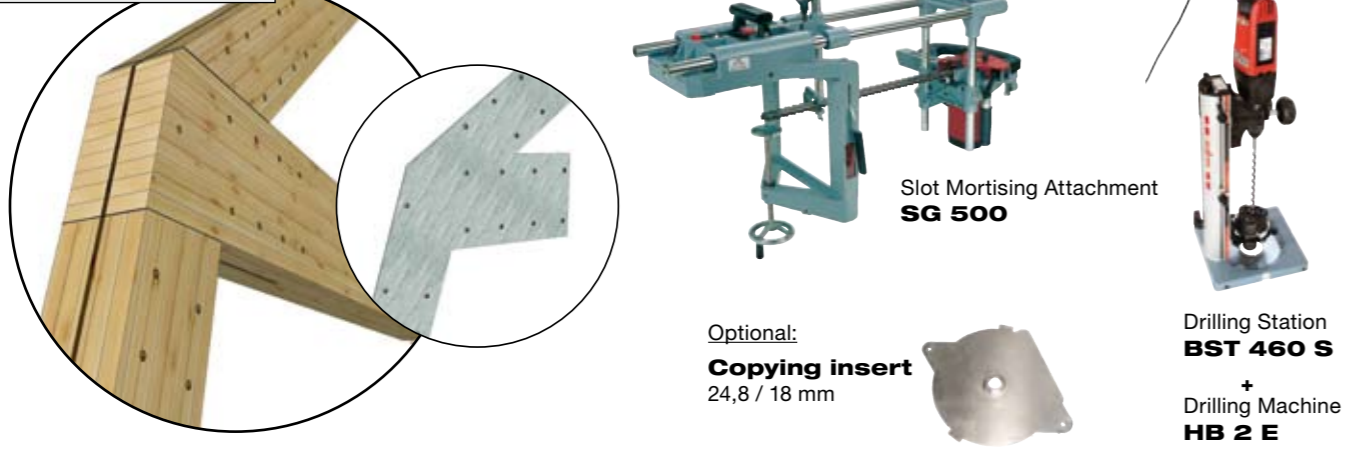

5. Dovetail joint*

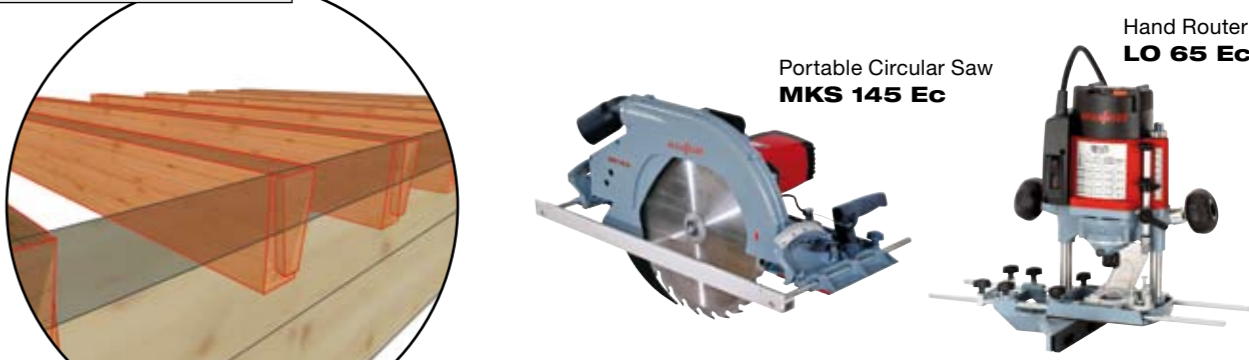

*Template for machining dovetail not available from MAFELL.

3. Post anchor



6. Birdsmouth



Machining examples: Tenoner ZAF 200



Tenon (straight, horizontal)



Tenon variant (extra thin)



Tenon (shouldered)



Corner half lap joint



Tenon (with mitered shoulders)



Steel beam joint



Tenon variant (straight)



Triangular notch in rafter for ridgeboard



Tenon (vertical, angled)



Ridge half lap joint



Rafters: Series production

Introduction
Rafters can be series-produced, e.g. for an entire roof face, quickly and for exact fitting.

After marking the pattern rafter, lay out all the rafters so that they are square, and then clamp and machine them with the appropriate tools.

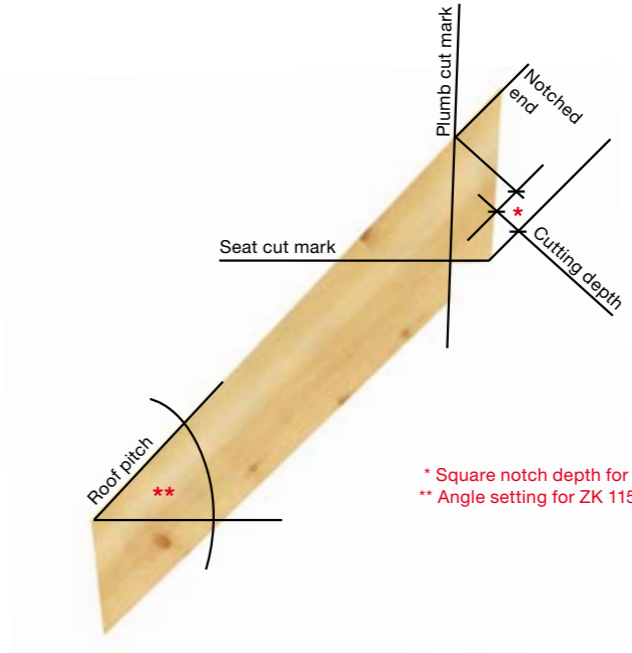
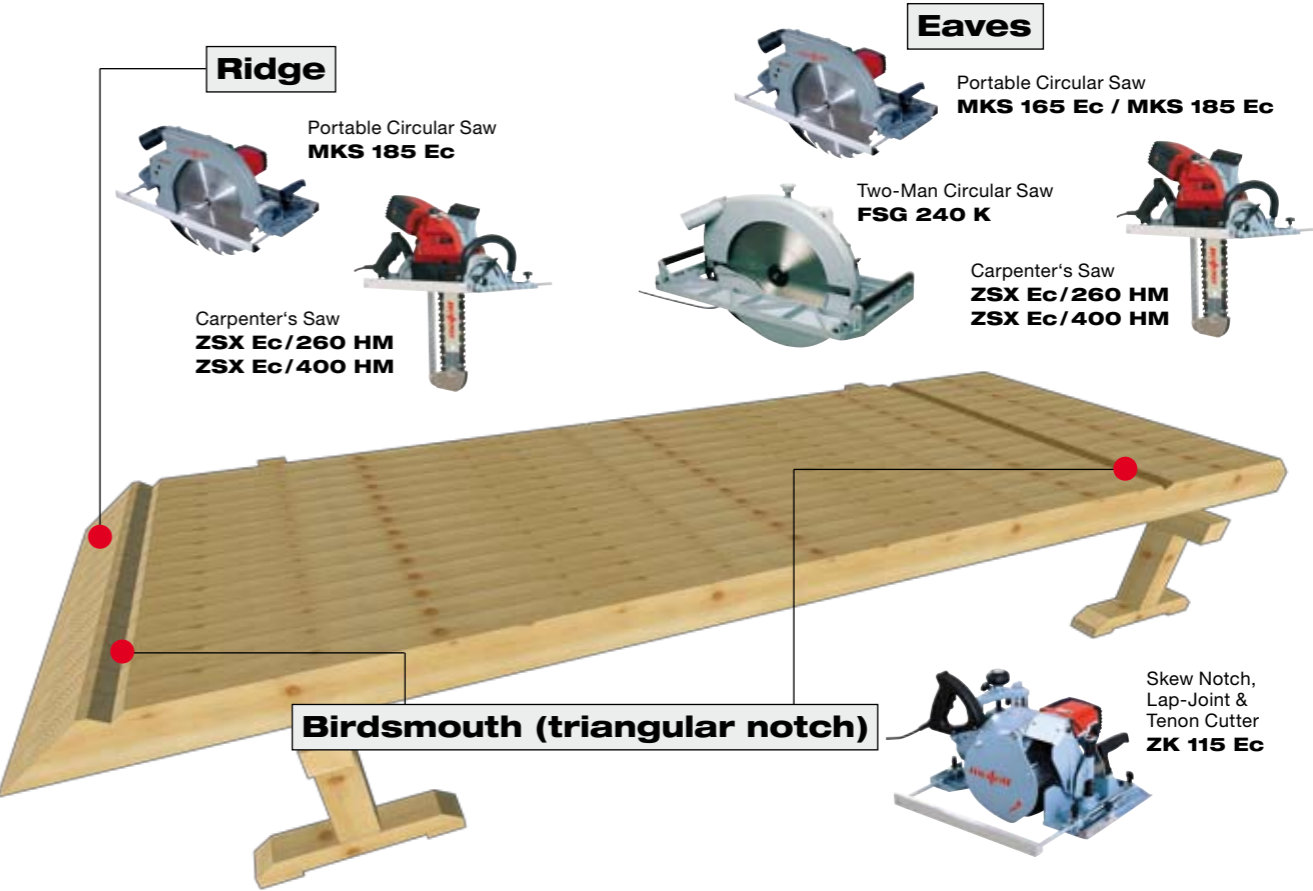

* Square notch depth for ZK 115 Ec
** Angle setting for ZK 115 Ec

The MAFELL cutting depth range.

Nobody else in the trade offers a wider variety of cutting depths than MAFELL. We start with our light KSP 40 with 40 mm of cutting capacity and finish our range up with our FSG 240 K offer you an

incredible cutting depth of more than 200 mm! If you need more – you get more! Our range of chain saws offer you 400 mm of clean and precise cutting. Which machine is now the best for you? Here is a little help for you:

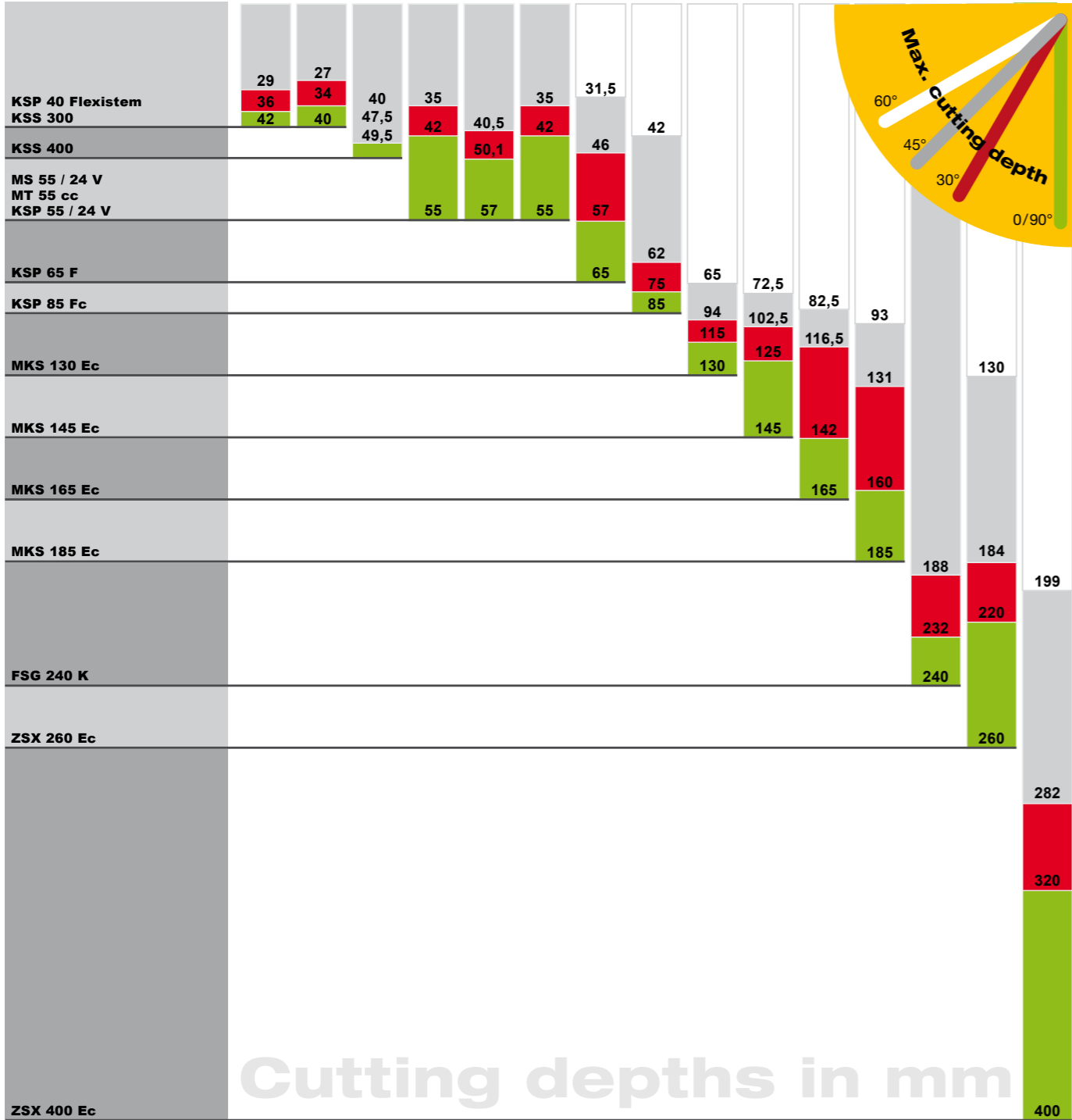

MAFELL cutting depth table

For machining with the ZK 115 Ec and various cutter heads

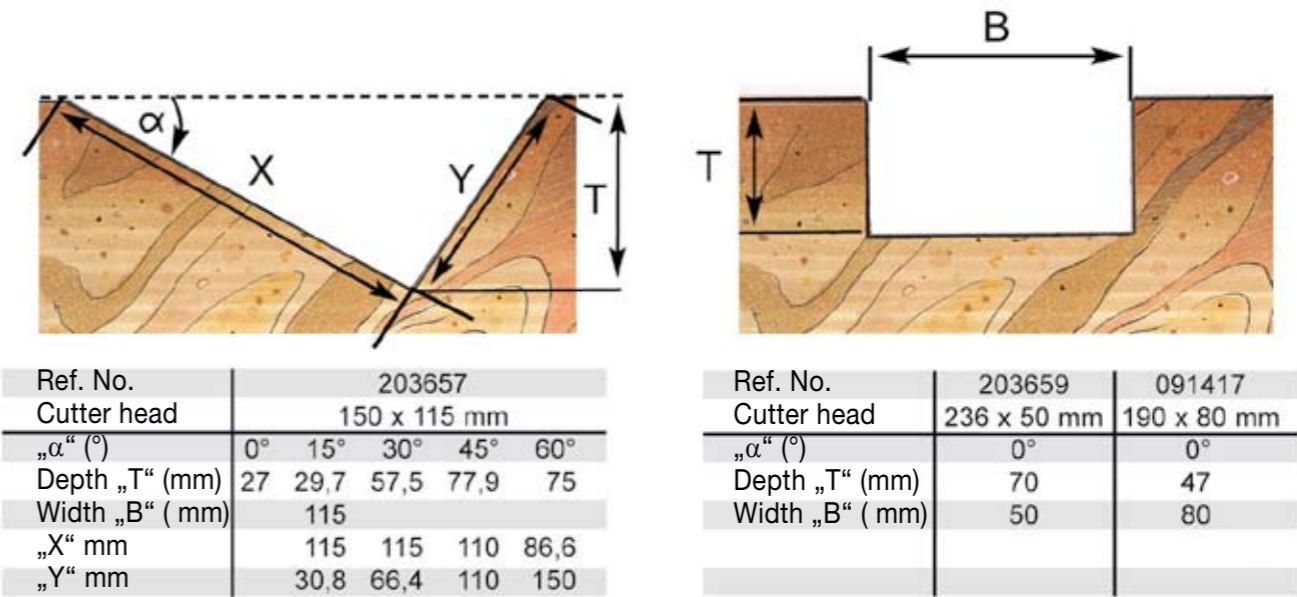

Any questions on the content of the training course?
In case you have any unresolved questions on issues covered by the course, please do not hesitate to contact me at any time.

Oliver Hähnle
Product Trainer
Phone +49 7423/812-203
Fax +49 7423/812-218
oliver.haehnle@mafell.de



Renderings produced with Dietrich's professional 3D CAD/CAM software.
Further information is available at www.dietrichs.com

Notes